

ACCESSORY



AK177-86E
AUGUST 11, 1976

Title STATIC DISCHARGER INSTALLATION



MODELS AFFECTED

177
177RG
F177RG

SERIALS AFFECTED

17702314 thru 17702522
177RG0788 thru 177RG1051
F177RG0139 thru F177RG0153

PARTS LIST:

QUANTITY	PART NUMBER	NOMENCLATURE
1	AN3-3A	Bolt
1	MS21044N3	Nut
3	AN515-8R6	Screw
3	MS35333-38	Washer
10	C592001-0201	Wick
6	MS20470A4-5	Rivet
3	MS21044N08	Nut
14	S2230-1	Rivet
3	1570102-1	Strap Assembly
1	1570102-12	Strap Assembly
1		Installation Instructions

CHANGE IN WEIGHT AND BALANCE:

WEIGHT INCREASE	. 3 pounds	(NET CHANGE)
ARM	223. 6 inches	
RESULTANT MOMENT	65. 3 pound-inches	
INDEX	0. 065	

1. DESCRIPTION OF INSTALLATION.

a. (Refer to figure 1.) Installation of this kit consists of:

- (1) Installing static discharger wicks on upper aileron surface.
- (2) Installing static discharger wicks on upper stabilator and trim tab surface.
- (3) Installing static discharger wicks on rudder.

2. INSTALLATION INSTRUCTIONS.

NOTES

- To ensure good contact clean all surfaces including connectors of straps and under surfaces of wicks, as well as aileron, rudder and stabilator where contact is made.
- Only wick base may be painted, and only after installation is complete.

NOTES

• Refer to the applicable Cessna Service Manual as a guide to cleaning, painting and balancing.

a. (Refer to figure 2.) Wick & Strap Installation - Aileron.

- (1) Remove fasteners securing wing tip (9) to wing structure. Move wing tip sufficiently to gain access to area shown in View D-D.
- (2) Drill hole (5) midway between rivets, as shown, and install small connector of strap (2) securing with screw, washer and nut (5).
- (3) Remove and replace bolt (4) installing the large connector of strap (2). Move ailerons from stop to stop and check for binding and correct if required.
- (4) Using wicks (8) as guides locate, mark, and drill holes (6).
- (5) Install wicks (8) securing with rivets (6).
- (6) Repeat above procedures on opposite aileron.

b. (Refer to figure 3.) Wick & Strap Installation - Stabilator.

- (1) Remove fasteners securing stinger and stinger cover plates. Remove stinger and plates from aircraft & retain.
- (2) Drill out second rivet from right that secures stiffener (11) and Plate (14). Enlarge hole size to #10 (.193) as shown in detail F.
- (3) Remove bolt, washer and nut (8) and install strap (9), on RH side of weight arm (15), securing with hardware (8) and to tailcone with bolt and nut (10).
- (4) Move stabilator from stop to stop and check for binding. Correct if required.
- (5) In accordance with dimensions shown locate and remove existing rivets (4).
- (6) Using wicks (5) as guides mark and drill holes (3) in accordance with dimensions shown.
- (7) Install wicks (5) securing with rivets (3 & 4).

c. (Refer to figure 4.) Wick & Strap Installation - Rudder.

- (1) Locate and drill hole (7) on rivet line and in accordance with dimension shown.
- (2) Locate and remove bolt and nut (8).
- (3) Install strap assembly (5) securing with screw, washer and nut (7) and bolt and nut (8). Move rudder from stop to stop and check for binding. Correct if required.
- (4) Using wicks (2) as guides mark and drill holes (3 & 4) in accordance with dimensions shown.
- (5) Install wicks (2) securing with rivets (3 & 4).
- (6) Paint wick bases and touch up control surfaces as required. DO NOT PAINT WICKS.
- (7) Rebalance control surfaces in accordance with the applicable Cessna Service Manual.
- (8) Reinstall wing tips, stinger and stinger cover plates.

- VIEW A - A: AILERON WICK INSTALLATION (REFER TO FIGURE 2)
VIEW B - B: STABILATOR WICK INSTALLATION (REFER TO FIGURE 3)
VIEW C - C: RUDDER WICK INSTALLATION (REFER TO FIGURE 4)
VIEW D - D: AILERON STRAP INSTALLATION (REFER TO FIGURE 2)
DETAIL E: RUDDER STRAP INSTALLATION (REFER TO FIGURE 4)
DETAIL F: STABILATOR STRAP INSTALLATION (REFER TO FIGURE 3)

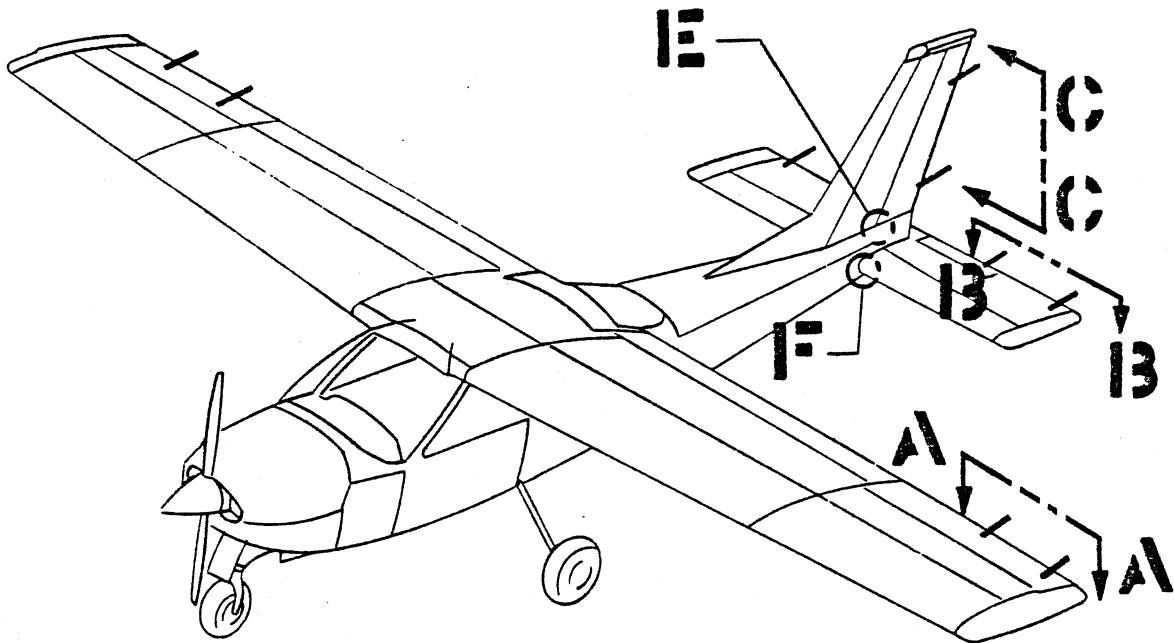

Figure 1. Static Discharger Installation.

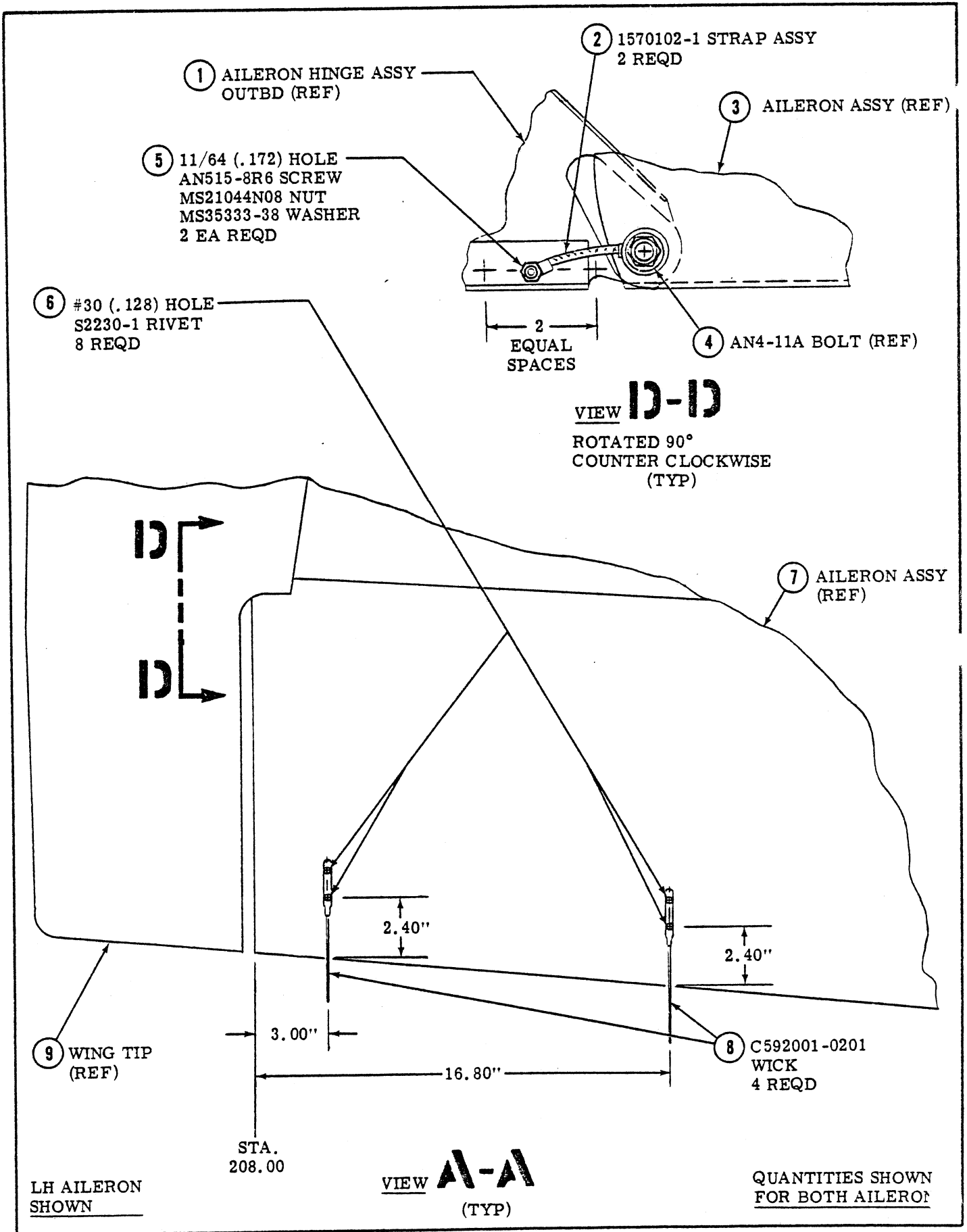

Figure 2. Wick and Strap Installation. (Aileron)

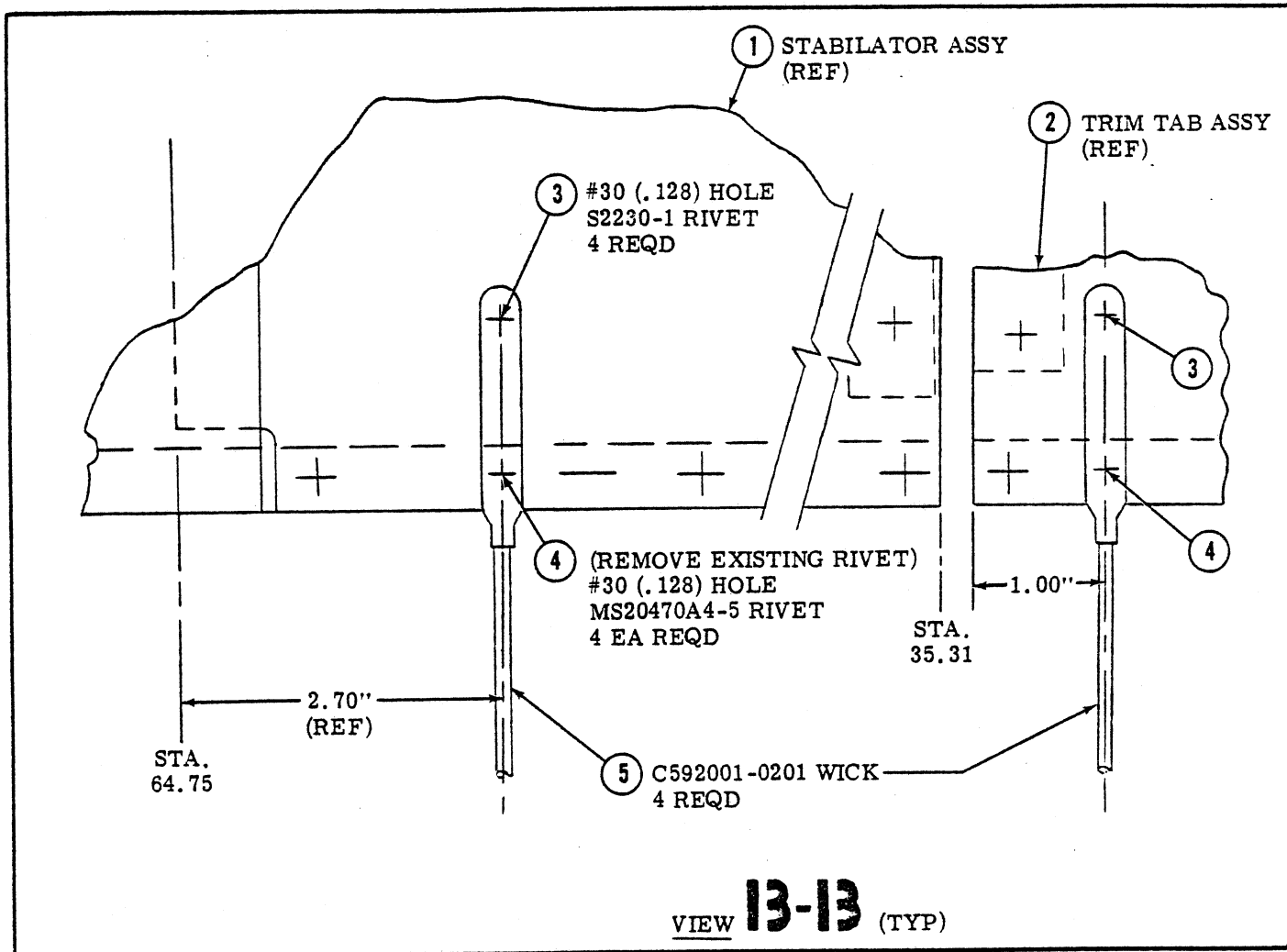

Figure 3. Wick and Strap Installation. (Stabilator) (sheet 1 of 2)

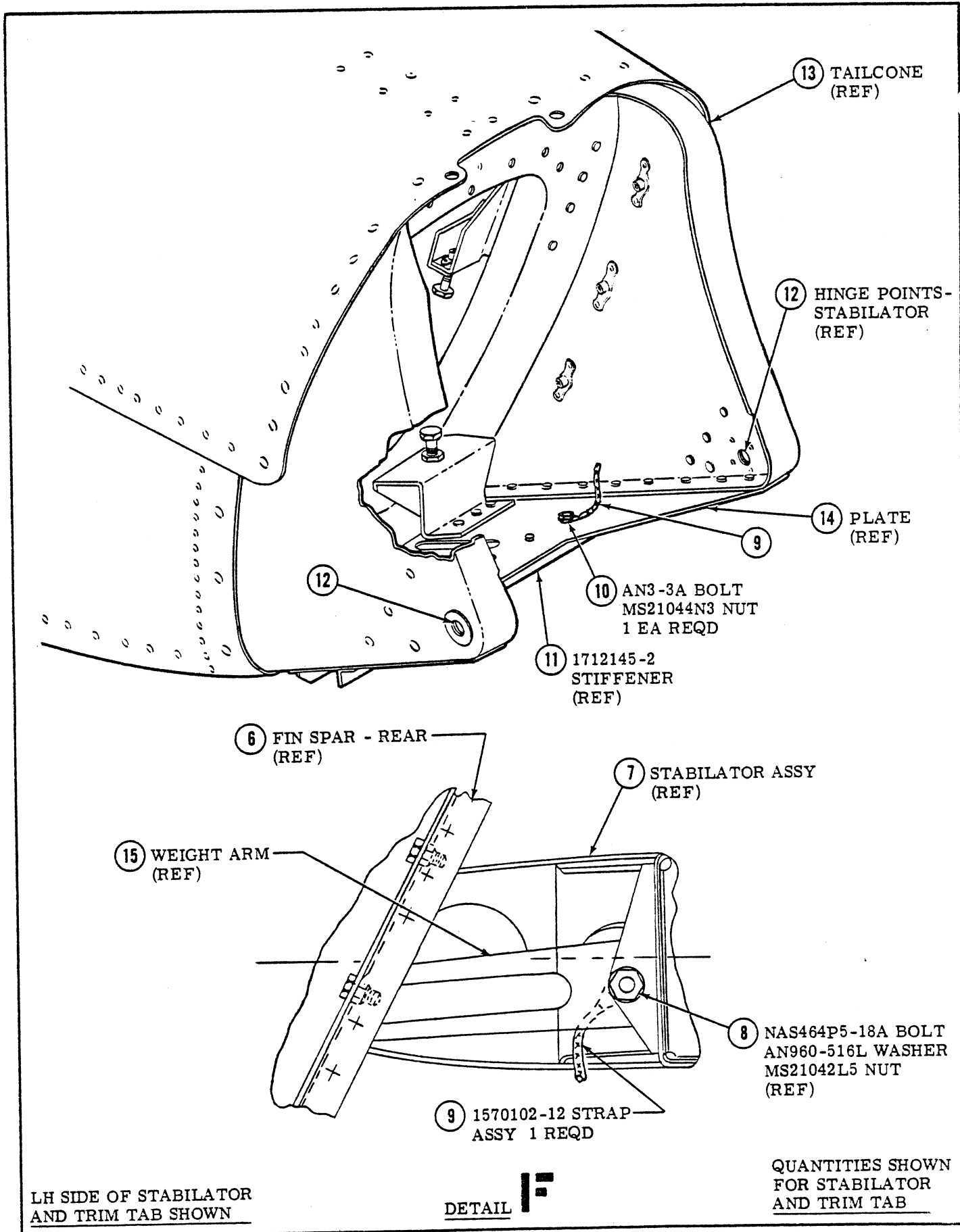

Figure 3. Wick and Strap Installation. (Stabilator) (sheet 2 of 2)

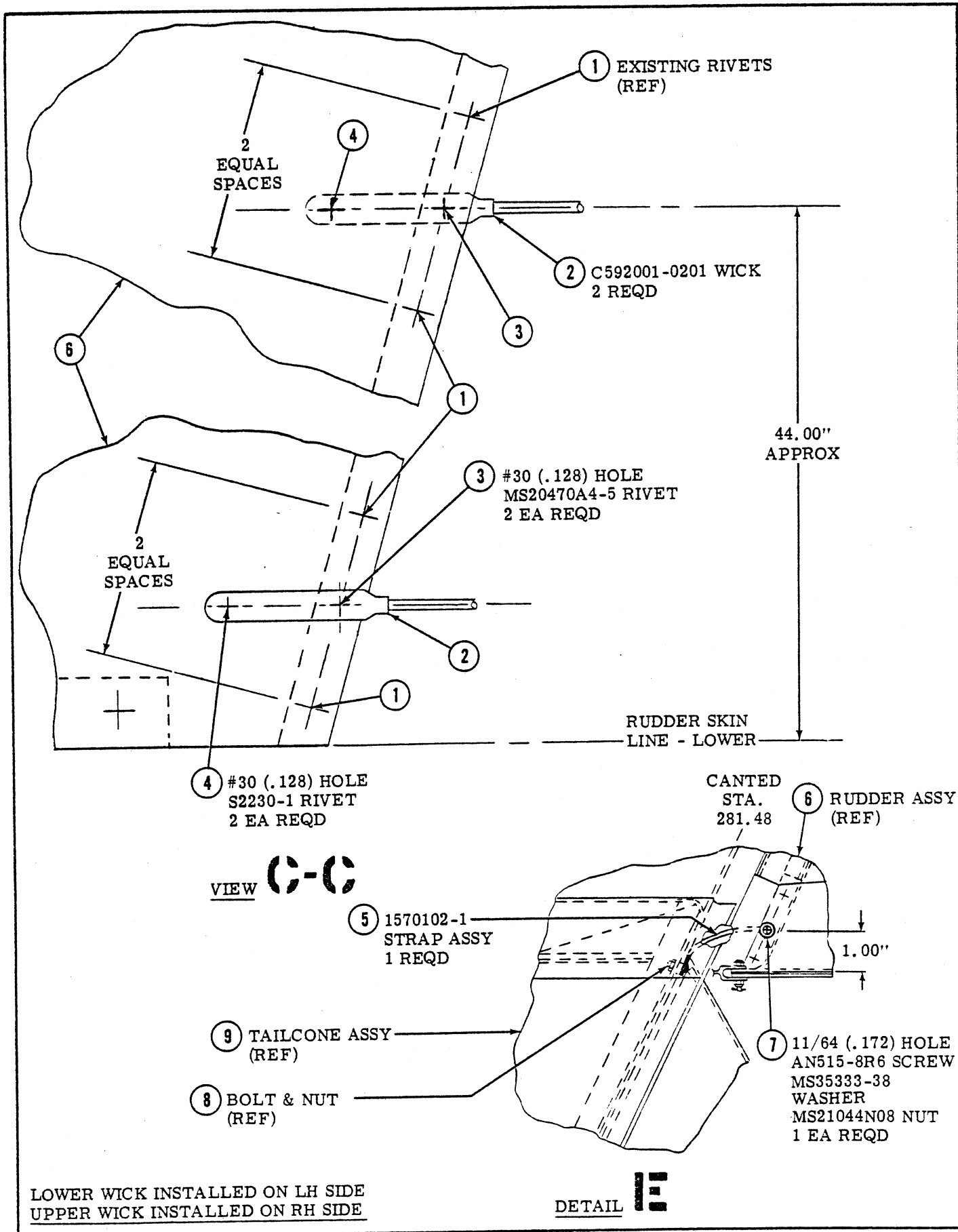

Figure 4. Wick and Strap Installation. (Rudder)